

# CI



**Long-range 300 °C/2h and 400 °C/2h centrifugal induction jet fans for use in fire risk zones with a low profile**



Long range 300 °C/2h and 400 °C/2h centrifugal induction jet fans for use in fire risk zones with a low profile.

**Fan:**

- Sheet steel casing.
- Backward curved impeller in highly robust sheet steel.
- IAT series safety switch built into the fan.
- Fixing feet included.

**Motor:**

- Class H motors for S1 continuous operation and S2 emergency use. With ball bearings, IP55 protection and 1 or 2 speeds, depending on model.

- Three-phase 230/400 V 50 Hz.

- Maximum temperature of air to be carried: S1 -20 °C +40 °C continuous service, also suitable for warm climates with temperatures up to 50 °C. S2 operation, 300 °C/2h, 400 °C/2h.

**Finish:**

- Anti-corrosive finish in polyester resin, polymerised at 190 °C, after degreasing with phosphate-free nanotechnology treatment.

## Order code

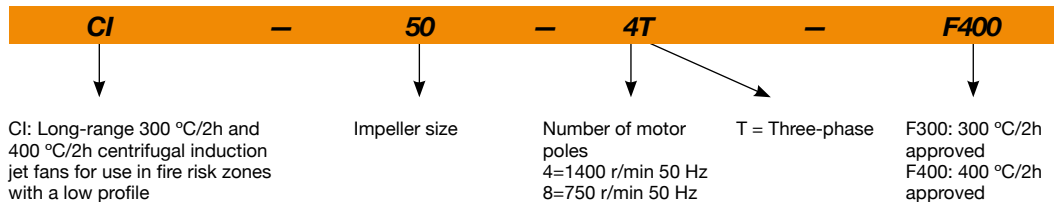

## Technical characteristics

Model	Speed (r/min)	Maximum admissible current (A)		Maximum flow rate (m³/h)	Thrust (N)	Impulsion speed (m/s)	Installed power (kW)	Sound pressure level <sup>1</sup> dB (A)	Approx. weight (Kg)
		230V	400V						
CI-50-4T	1395	5.00	2.90	6050	50	23.5	1.20	64	83
CI-50-4/8T	1395 / 650		2.90 / 1.20	6050 / 2820	50 / 23	23.5 / 10.9	1.20 / 0.30	64 / 47	83
CI-75-4/8T	1450 / 730		5.20 / 2.05	8080 / 4070	75 / 38	26.3 / 13.2	2.20 / 0.37	65 / 50	139
CI-100-4T	1445	9.90	5.70	9340	100	30.0	2.40	67	141
CI-100-4/8T	1445 / 715		5.70 / 2.20	9340 / 4625	100 / 49	30.0 / 14.8	2.40 / 0.55	67 / 51	141

<sup>1</sup> Sound pressure level in dB(A) at a distance of 10 m and at maximum flow rate.

## Acoustic characteristics

Sound power spectrum Lw(A) in dB(A) per Hz frequency band

	63	125	250	500	1000	2000	4000	8000		63	125	250	500	1000	2000	4000	8000
CI-50-4T	63	75	82	86	88	85	81	75	CI-75-4/8T (2V)	50	67	69	73	74	68	64	60
CI-50-4/8T	63	75	82	86	88	85	81	75	CI-100-4T	68	85	87	89	90	85	80	73
CI-50-4/8T (2V)	46	58	65	69	71	68	64	58	CI-100-4/8T	68	85	87	89	90	85	80	73
CI-75-4/8T	65	82	84	88	89	83	79	75	CI-100-4/8T (2V)	52	69	71	73	74	69	64	57

## Dimensions mm

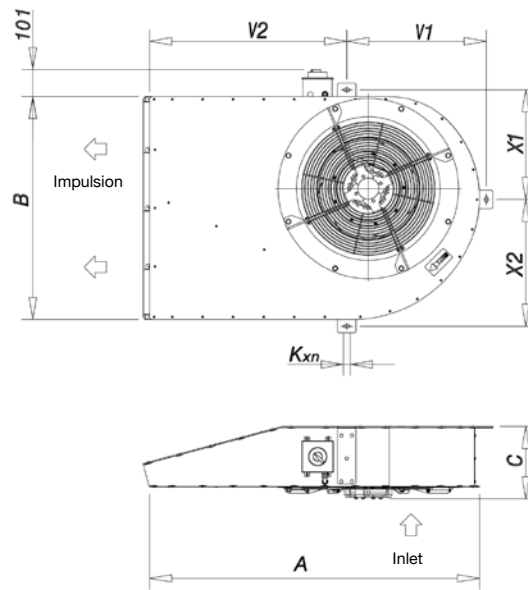

	A	B	C	V2	V1	X1	X2	Kxn
CI-50-F300	1240	840	272.5	741.5	524.5	413	477	12x26
CI-50-F400	1240	840	261.5	741.5	524.5	413	477	12x26
CI-75-F300	1778	1040	311	1143	662	494	596	12x26
CI-75-F400	1778	1040	299	1143	662	494	596	12x26
CI-100 F-300	1778	1040	323	1143	662	494	596	12x26
CI-100 F-400	1778	1040	323	1143	662	494	596	12x26

## Accessories



INT



IAT



CABLE BOX



C2V



AET



CENTRAL CO



VSD3/A-RFT  
- VSD1/A-RFM



P-400



BOXPARK

## Configuration with BOXPARK



**Control panels for car park ventilation systems with triple purpose: daily ventilation, CO concentration control and smoke extraction in case of fire**

Control panels in metal enclosure with all the necessary elements for the management and control of fans in car park ventilation systems, whether they are based on duct networks or impulse fans, for the control of CO concentration levels and smoke extraction in case of fire. Customised panels for all power ratings and number of fans according to project requirements.

More information see BOXPARK series.

## Installation examples with BOXPARK

