



# CENTRIFUGAL FANS AND IN-LINE DUCT EXTRACTOR FANS

## Technical characteristics

| Model                      | Speed<br>(r/min) | Maximum admissible current (A) |       |       | Installed power<br>(kW) | Maximum flow rate<br>m <sup>3</sup> /h | Sound pressure level<br>dB(A) | Approx. weight<br>(kg) | Mounting type | According to ErP |
|----------------------------|------------------|--------------------------------|-------|-------|-------------------------|--|-------------------------------|------------------------|---------------|------------------|
|                            |                  | 230 V                          | 400 V | 690 V |                         |  |                               |                        |               |                  |
| CJBX CJBX/AL 9/9-0.5       | 1020             | 2.02                           | 1.17  |       | 0.37                    | 2200                                   | 51                            | 52                     | A             | 2018             |
| CJBX CJBX/AL 9/9-0.75      | 1050             | 2.92                           | 1.69  |       | 0.55                    | 2900                                   | 55                            | 55                     | A             | 2018             |
| CJBX CJBX/AL 9/9-1 IE3     | 1070             | 3.10                           | 1.79  |       | 0.75                    | 3200                                   | 56                            | 56                     | A             | 2018             |
| CJBX CJBX/AL 9/9-1.5 IE3   | 1260             | 4.03                           | 2.32  |       | 1.10                    | 3750                                   | 60                            | 59                     | A             | 2018             |
| CJBX CJBX/AL 10/10-0.75    | 845              | 2.92                           | 1.69  |       | 0.55                    | 3800                                   | 56                            | 57                     | A             | 2018             |
| CJBX CJBX/AL 10/10-1 IE3   | 960              | 3.10                           | 1.79  |       | 0.75                    | 4175                                   | 58                            | 59                     | A             | 2018             |
| CJBX CJBX/AL 10/10-1.5 IE3 | 1070             | 4.03                           | 2.32  |       | 1.10                    | 4800                                   | 61                            | 61                     | A             | 2018             |
| CJBX CJBX/AL 10/10-2 IE3   | 1140             | 5.96                           | 3.44  |       | 1.50                    | 5400                                   | 63                            | 65                     | A             | 2018             |
| CJBX CJBX/AL 12/12-0.5     | 595              | 2.02                           | 1.17  |       | 0.37                    | 4200                                   | 52                            | 69                     | A             | 2018             |
| CJBX CJBX/AL 12/12-0.75    | 675              | 2.92                           | 1.69  |       | 0.55                    | 4800                                   | 54                            | 71                     | A             | 2018             |
| CJBX CJBX/AL 12/12-1 IE3   | 765              | 3.10                           | 1.79  |       | 0.75                    | 5400                                   | 57                            | 72                     | A             | 2018             |
| CJBX CJBX/AL 12/12-1.5 IE3 | 855              | 4.03                           | 2.32  |       | 1.10                    | 5800                                   | 59                            | 75                     | A             | 2018             |
| CJBX CJBX/AL 12/12-2 IE3   | 965              | 5.96                           | 3.44  |       | 1.50                    | 6500                                   | 62                            | 79                     | A             | 2018             |
| CJBX CJBX/AL 12/12-3 IE3   | 1180             | 8.36                           | 4.83  |       | 2.20                    | 7400                                   | 65                            | 87                     | A             | 2018             |
| CJBX CJBX/AL 15/15-0.75    | 525              | 2.92                           | 1.69  |       | 0.55                    | 5900                                   | 49                            | 85                     | B             | 2018             |
| CJBX CJBX/AL 15/15-1 IE3   | 595              | 3.10                           | 1.79  |       | 0.75                    | 6500                                   | 52                            | 86                     | B             | 2018             |
| CJBX CJBX/AL 15/15-1.5 IE3 | 635              | 4.03                           | 2.32  |       | 1.10                    | 7500                                   | 54                            | 89                     | B             | 2018             |
| CJBX CJBX/AL 15/15-2 IE3   | 670              | 5.96                           | 3.44  |       | 1.50                    | 8200                                   | 56                            | 93                     | B             | 2018             |
| CJBX CJBX/AL 15/15-3 IE3   | 740              | 8.36                           | 4.83  |       | 2.20                    | 9500                                   | 59                            | 101                    | B             | 2018             |
| CJBX CJBX/AL 15/15-4 IE3   | 805              | 10.96                          | 6.33  |       | 3.00                    | 10600                                  | 61                            | 103                    | B             | 2018             |
| CJBX CJBX/AL 18/18-1.5 IE3 | 480              | 4.03                           | 2.32  |       | 1.10                    | 9000                                   | 48                            | 122                    | B             | 2018             |
| CJBX CJBX/AL 18/18-2 IE3   | 605              | 5.96                           | 3.44  |       | 1.50                    | 9250                                   | 51                            | 125                    | B             | 2018             |
| CJBX CJBX/AL 18/18-3 IE3   | 590              | 8.36                           | 4.83  |       | 2.20                    | 11500                                  | 54                            | 134                    | B             | 2018             |
| CJBX CJBX/AL 18/18-4 IE3   | 640              | 10.96                          | 6.33  |       | 3.00                    | 13200                                  | 56                            | 136                    | B             | 2018             |
| CJBX CJBX/AL 18/18-5.5 IE3 | 675              | 14.10                          | 8.12  |       | 4.00                    | 15000                                  | 58                            | 141                    | B             | 2018             |
| CJBX CJBX/AL 18/18-7.5 IE3 | 760              |                                | 11.60 | 6.72  | 5.50                    | 17000                                  | 60                            | 155                    | B             | 2018             |
| CJBX CJBX/AL 20/20-2 IE3   | 430              | 5.96                           | 3.44  |       | 1.50                    | 11500                                  | 56                            | 222                    | B             | 2018             |
| CJBX CJBX/AL 20/20-3 IE3   | 530              | 8.36                           | 4.83  |       | 2.20                    | 12800                                  | 57                            | 231                    | B             | 2018             |
| CJBX CJBX/AL 20/20-4 IE3   | 575              | 10.96                          | 6.33  |       | 3.00                    | 14200                                  | 58                            | 233                    | B             | 2018             |
| CJBX CJBX/AL 20/20-5.5 IE3 | 635              | 14.10                          | 8.12  |       | 4.00                    | 15500                                  | 61                            | 238                    | B             | 2018             |
| CJBX CJBX/AL 20/20-7.5 IE3 | 675              |                                | 11.60 | 6.72  | 5.50                    | 17500                                  | 63                            | 252                    | B             | 2018             |
| CJBX CJBX/AL 20/20-10 IE3  | 725              |                                | 13.90 | 8.06  | 7.50                    | 20000                                  | 65                            | 283                    | B             | 2018             |
| CJBX CJBX/AL 22/22-2 IE3   | 385              | 5.96                           | 3.44  |       | 1.50                    | 14000                                  | 50                            | 250                    | B             | 2018             |
| CJBX CJBX/AL 22/22-3 IE3   | 475              | 8.36                           | 4.83  |       | 2.20                    | 15000                                  | 54                            | 257                    | B             | 2018             |
| CJBX CJBX/AL 22/22-4 IE3   | 515              | 10.96                          | 6.33  |       | 3.00                    | 17000                                  | 55                            | 261                    | B             | 2018             |
| CJBX CJBX/AL 22/22-5.5 IE3 | 570              | 14.10                          | 8.12  |       | 4.00                    | 19000                                  | 57                            | 265                    | B             | 2018             |
| CJBX CJBX/AL 22/22-7.5 IE3 | 605              |                                | 11.60 | 6.72  | 5.50                    | 21500                                  | 60                            | 279                    | B             | 2018             |
| CJBX CJBX/AL 22/22-10 IE3  | 675              |                                | 13.90 | 8.06  | 7.50                    | 25000                                  | 63                            | 306                    | B             | 2018             |
| CJBX CJBX/AL 22/22-15 IE3  | 765              |                                | 20.90 | 12.10 | 11.00                   | 27000                                  | 65                            | 341                    | B             | 2018             |
| CJBX CJBX/AL 25/25-3 IE3   | 375              | 8.36                           | 4.83  |       | 2.20                    | 17000                                  | 53                            | 297                    | B             | 2018             |
| CJBX CJBX/AL 25/25-4 IE3   | 405              | 10.96                          | 6.33  |       | 3.00                    | 20500                                  | 55                            | 299                    | B             | 2018             |
| CJBX CJBX/AL 25/25-5.5 IE3 | 450              | 14.10                          | 8.12  |       | 4.00                    | 22000                                  | 57                            | 304                    | B             | 2018             |
| CJBX CJBX/AL 25/25-7.5 IE3 | 485              |                                | 11.60 | 6.72  | 5.50                    | 24500                                  | 59                            | 318                    | B             | 2018             |
| CJBX CJBX/AL 25/25-10 IE3  | 545              |                                | 13.90 | 8.06  | 7.50                    | 28000                                  | 61                            | 345                    | B             | 2018             |
| CJBX CJBX/AL 25/25-15 IE3  | 610              |                                | 20.90 | 12.10 | 11.00                   | 32000                                  | 64                            | 374                    | B             | 2018             |
| CJBX CJBX/AL 30/28-3 IE3   | 330              | 8.36                           | 4.83  |       | 2.20                    | 20000                                  | 54                            | 380                    | B             | 2018             |
| CJBX CJBX/AL 30/28-4 IE3   | 360              | 10.96                          | 6.33  |       | 3.00                    | 22000                                  | 56                            | 382                    | B             | 2018             |
| CJBX CJBX/AL 30/28-5.5 IE3 | 380              | 14.10                          | 8.12  |       | 4.00                    | 25000                                  | 59                            | 387                    | B             | 2018             |
| CJBX CJBX/AL 30/28-7.5 IE3 | 380              |                                | 11.60 | 6.72  | 5.50                    | 31500                                  | 60                            | 402                    | B             | 2018             |
| CJBX CJBX/AL 30/28-10 IE3  | 410              |                                | 13.90 | 8.06  | 7.50                    | 36000                                  | 63                            | 431                    | B             | 2018             |
| CJBX CJBX/AL 30/28-15 IE3  | 430              |                                | 20.90 | 12.10 | 11.00                   | 42000                                  | 65                            | 451                    | B             | 2018             |
| CJBX CJBX/AL 30/28-20 IE3  | 480              |                                | 27.90 | 16.20 | 15.00                   | 48000                                  | 68                            | 466                    | B             | 2018             |



### Erp. (Energy Related Products)

Information on Directive 2009/125/EC can be downloaded from the SODECA website or the QuickFan selector programme.

## Dimensions mm

**CJBX**  
Standard supply  
Horizontal impulsion  
(H) LG 90

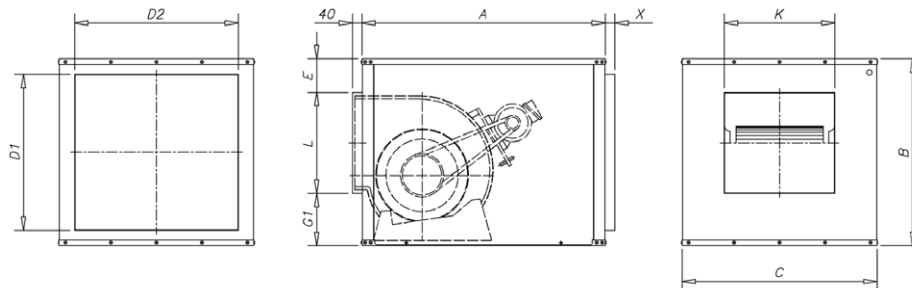

**CJBX/F**

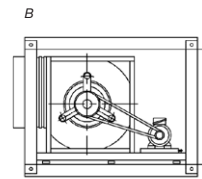
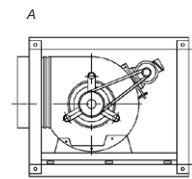
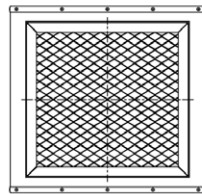

|            | A    | B    | C    | D1   | D2   | E   | G1  | L   | K   | X (without filter) | X (with filter) |
|------------|------|------|------|------|------|-----|-----|-----|-----|--------------------|-----------------|
| CJBX-7/7   | 650  | 460  | 500  | 364  | 404  | 107 | 135 | 218 | 240 | 30                 | 40              |
| CJBX-9/9   | 700  | 522  | 550  | 426  | 454  | 101 | 151 | 270 | 310 | 30                 | 40              |
| CJBX-10/10 | 750  | 575  | 600  | 479  | 504  | 100 | 175 | 300 | 336 | 30                 | 40              |
| CJBX-12/12 | 850  | 650  | 700  | 554  | 604  | 84  | 205 | 361 | 404 | 30                 | 40              |
| CJBX-15/15 | 1000 | 755  | 800  | 659  | 704  | 62  | 270 | 423 | 486 | 30                 | 40              |
| CJBX-18/18 | 1200 | 875  | 1000 | 779  | 904  | 45  | 336 | 494 | 551 | 30                 | 40              |
| CJBX-20/20 | 1400 | 1175 | 1100 | 1079 | 1004 | 147 | 428 | 600 | 600 | 30                 | 40              |
| CJBX-22/22 | 1460 | 1250 | 1250 | 1154 | 1154 | 145 | 413 | 692 | 653 | 30                 | 40              |
| CJBX-25/25 | 1550 | 1375 | 1450 | 1279 | 1354 | 152 | 431 | 792 | 762 | 30                 | 40              |
| CJBX-30/28 | 1800 | 1600 | 1650 | 1504 | 1554 | 140 | 528 | 932 | 885 | 30                 | 40              |

**On request**  
vertical impulsion  
(V) LG 0

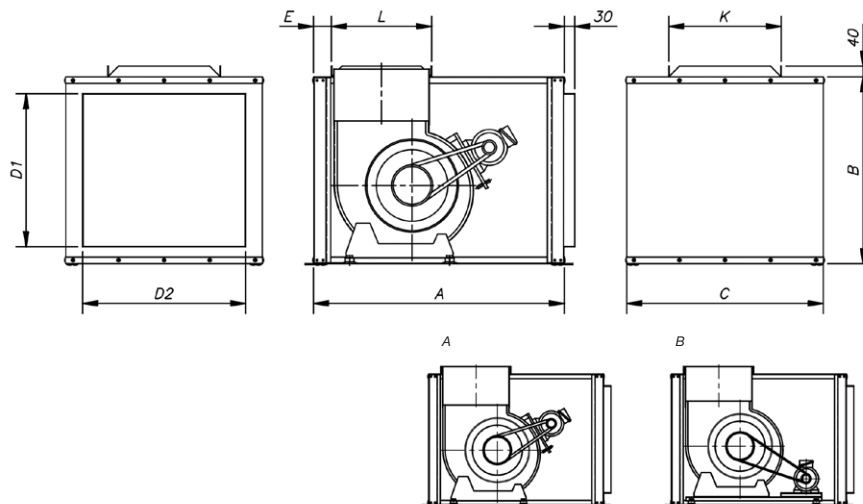

|            | A    | B    | C    | D1xD2     | E  | L   | K   |
|------------|------|------|------|-----------|----|-----|-----|
| CJBX-7/7   | 650  | 460  | 500  | 364x404   | 30 | 204 | 226 |
| CJBX-9/9   | 700  | 522  | 550  | 426x454   | 30 | 256 | 296 |
| CJBX-10/10 | 750  | 575  | 600  | 479x504   | 30 | 286 | 322 |
| CJBX-12/12 | 850  | 650  | 700  | 554x604   | 30 | 341 | 383 |
| CJBX-15/15 | 1000 | 755  | 800  | 659x704   | 30 | 404 | 471 |
| CJBX-18/18 | 1200 | 875  | 1000 | 779x904   | 30 | 484 | 537 |
| CJBX-20/20 | 1445 | 1175 | 1100 | 1079x1004 | 60 | 600 | 600 |
| CJBX-22/22 | 1580 | 1250 | 1250 | 1154x1154 | 60 | 692 | 653 |
| CJBX-25/25 | 1675 | 1375 | 1450 | 1279x1354 | 60 | 792 | 762 |
| CJBX-30/28 | 1935 | 1600 | 1650 | 1504x1554 | 60 | 932 | 885 |

# CENTRIFUGAL FANS AND IN-LINE DUCT EXTRACTOR FANS

## Dimensions mm

**CJBX/AL**  
Standard supply  
Horizontal impulsion  
(H) LG 90

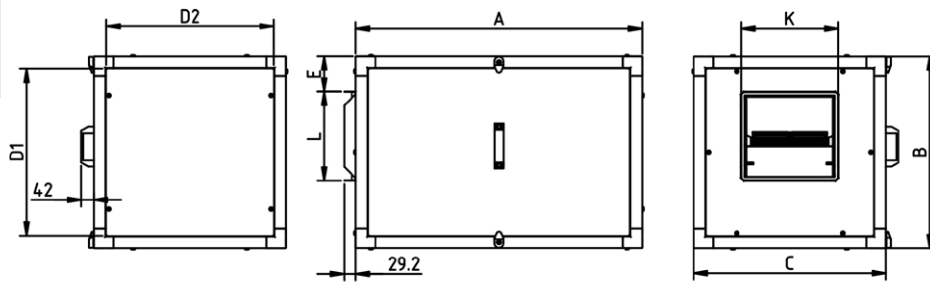

**CJBX/ALF**

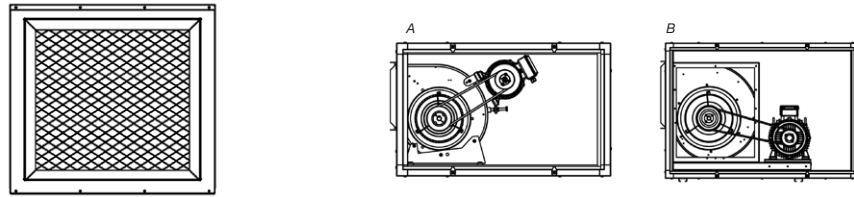

|                                     | A    | B    | C    | D1   | D2   | E   | L   | K   | MOUNTING |
|-------------------------------------|------|------|------|------|------|-----|-----|-----|----------|
| CJBX-AL / CJBX-ALS / CJBX-ALF 7/7   | 830  | 490  | 490  | 428  | 428  | 91  | 226 | 247 | A        |
| CJBX-AL / CJBX-ALS / CJBX-ALF 9/9   | 920  | 550  | 550  | 488  | 488  | 86  | 279 | 317 | A        |
| CJBX-AL / CJBX-ALS / CJBX-ALF 10/10 | 970  | 605  | 605  | 543  | 543  | 88  | 306 | 343 | A        |
| CJBX-AL / CJBX-ALS / CJBX-ALF 12/12 | 1050 | 680  | 680  | 618  | 618  | 84  | 360 | 404 | A        |
| CJBX-AL / CJBX-ALS / CJBX-ALF 15/15 | 1220 | 855  | 855  | 793  | 793  | 119 | 423 | 490 | B        |
| CJBX-AL / CJBX-ALS / CJBX-ALF 18/18 | 1356 | 1000 | 1000 | 938  | 938  | 137 | 498 | 554 | B        |
| CJBX-AL / CJBX-ALS / CJBX-ALF 20/20 | 1500 | 1195 | 1195 | 1115 | 1115 | 140 | 615 | 615 | B        |
| CJBX-AL / CJBX-ALS / CJBX-ALF 22/22 | 1600 | 1250 | 1250 | 1170 | 1170 | 104 | 705 | 668 | B        |
| CJBX-AL / CJBX-ALS / CJBX-ALF 25/25 | 1870 | 1450 | 1450 | 1370 | 1370 | 200 | 792 | 767 | B        |
| CJBX-AL / CJBX-ALS / CJBX-ALF 30/28 | 1975 | 1670 | 1670 | 1590 | 1590 | 188 | 938 | 896 | B        |

**CJBX/AL**  
On request  
vertical impulsion  
(V) LG 0

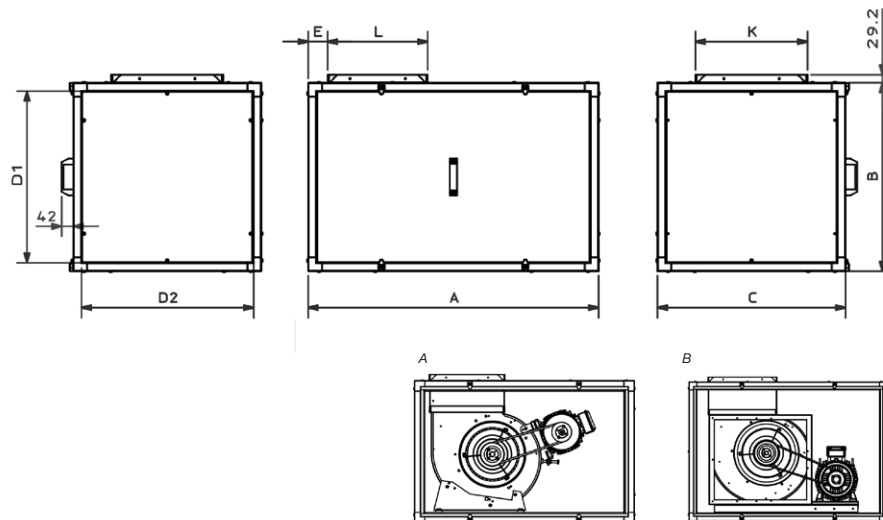

|                                     | A    | B    | C    | D1   | D2   | E   | L   | K   | MOUNTING |
|-------------------------------------|------|------|------|------|------|-----|-----|-----|----------|
| CJBX-AL / CJBX-ALS / CJBX-ALF 7/7   | 830  | 490  | 490  | 428  | 428  | 63  | 226 | 247 | A        |
| CJBX-AL / CJBX-ALS / CJBX-ALF 9/9   | 920  | 550  | 500  | 488  | 488  | 85  | 279 | 317 | A        |
| CJBX-AL / CJBX-ALS / CJBX-ALF 10/10 | 970  | 605  | 605  | 543  | 543  | 87  | 306 | 343 | A        |
| CJBX-AL / CJBX-ALS / CJBX-ALF 12/12 | 1050 | 680  | 680  | 618  | 618  | 69  | 360 | 404 | A        |
| CJBX-AL / CJBX-ALS / CJBX-ALF 15/15 | 1220 | 855  | 855  | 793  | 793  | 115 | 423 | 490 | B        |
| CJBX-AL / CJBX-ALS / CJBX-ALF 18/18 | 1356 | 1000 | 1000 | 938  | 938  | 80  | 498 | 554 | B        |
| CJBX-AL / CJBX-ALS / CJBX-ALF 20/20 | 1500 | 1195 | 1195 | 1115 | 1115 | 125 | 615 | 615 | B        |
| CJBX-AL / CJBX-ALS / CJBX-ALF 22/22 | 1600 | 1250 | 1250 | 1170 | 1170 | 125 | 705 | 668 | B        |
| CJBX-AL / CJBX-ALS / CJBX-ALF 25/25 | 1870 | 1450 | 1450 | 1370 | 1370 | 85  | 792 | 767 | B        |
| CJBX-AL / CJBX-ALS / CJBX-ALF 30/28 | 1975 | 1670 | 1670 | 1590 | 1590 | 155 | 938 | 896 | B        |

### Characteristic curves

Q= Flow rate in m<sup>3</sup>/h, m<sup>3</sup>/s and cfm

Pe= Static pressure in mm H<sub>2</sub>O, Pa and inwg

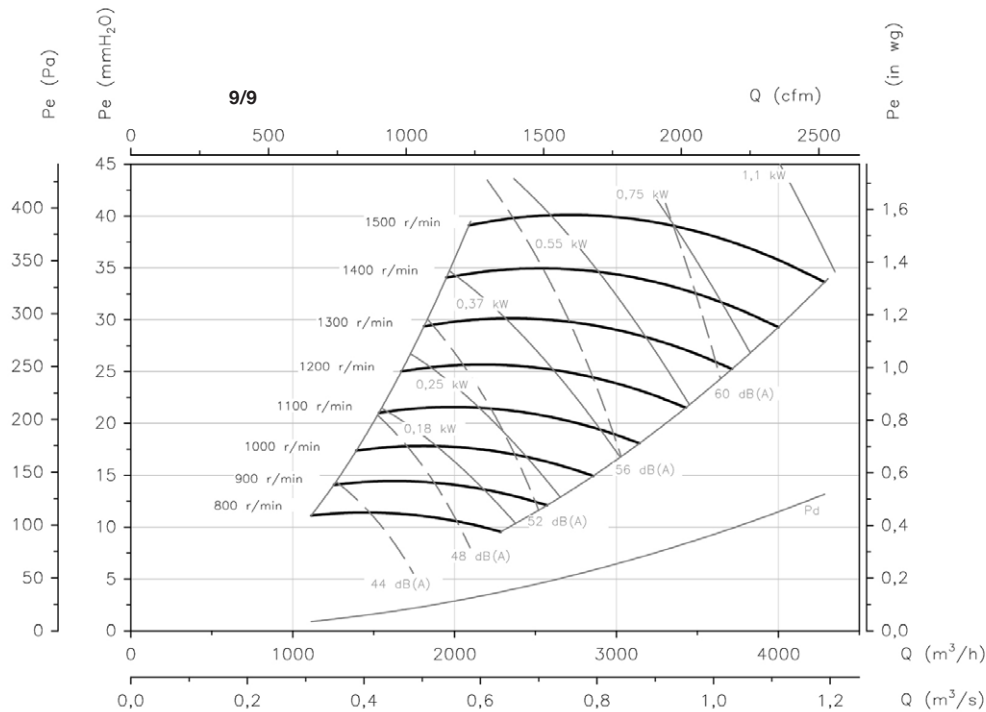
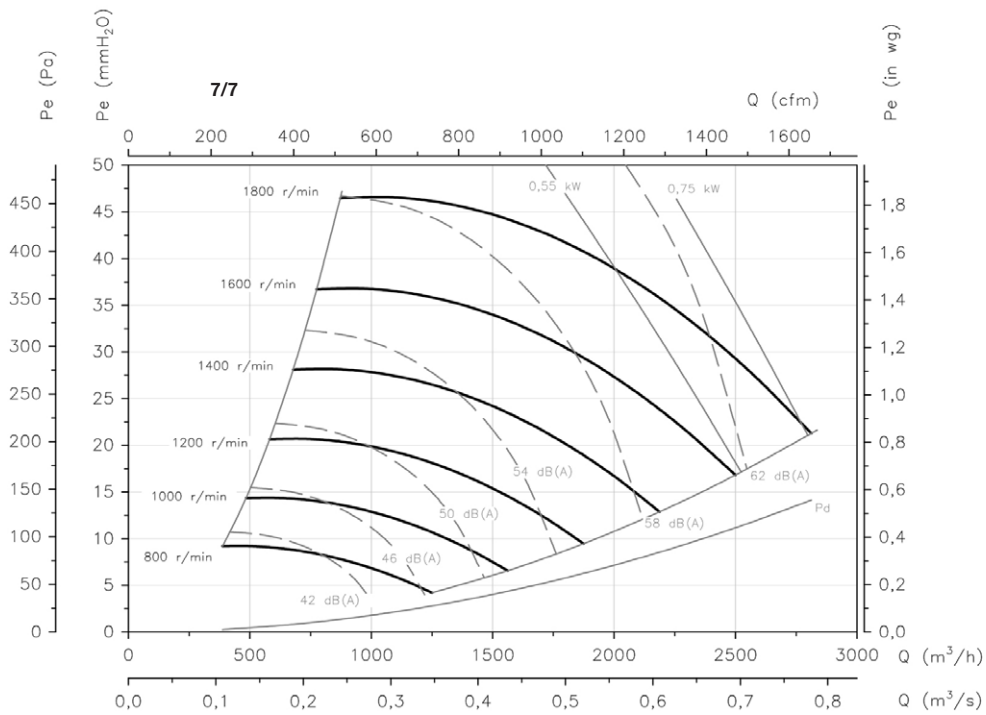

# CENTRIFUGAL FANS AND IN-LINE DUCT EXTRACTOR FANS

## Characteristic curves

Q= Flow rate in m<sup>3</sup>/h, m<sup>3</sup>/s and cfm

Pe= Static pressure in mm H<sub>2</sub>O, Pa and inwg

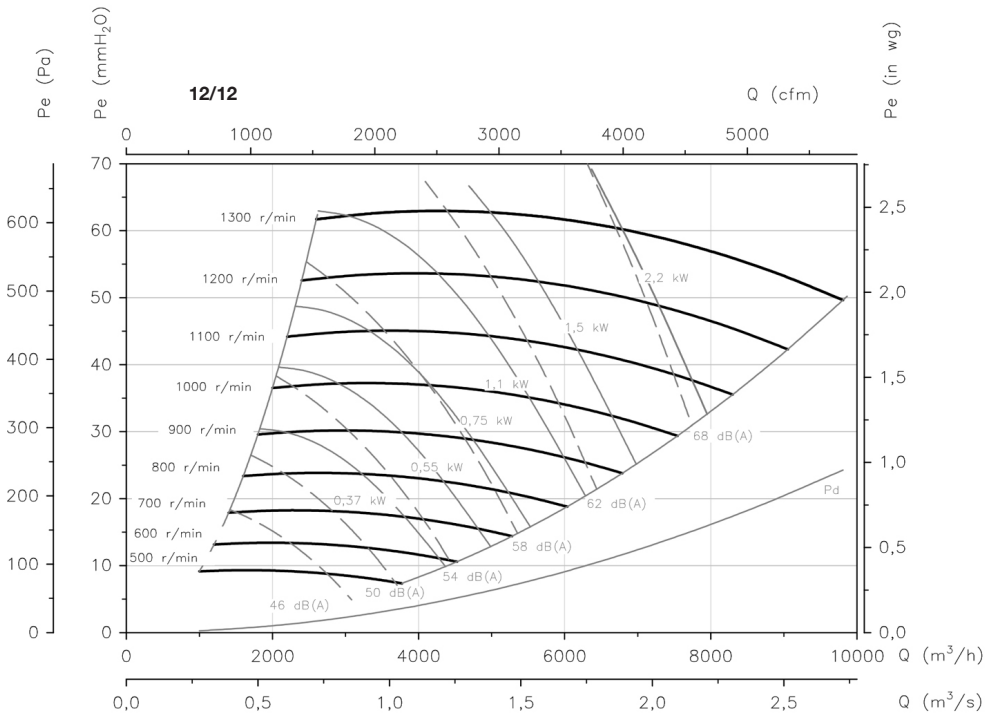
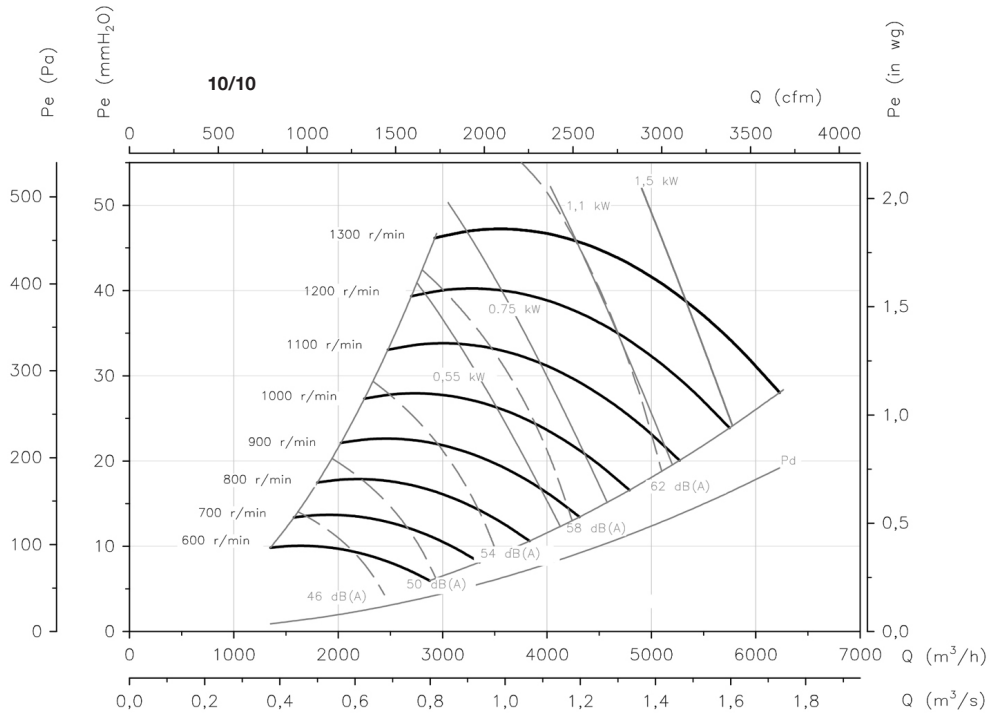

### Characteristic curves

Q= Flow rate in m<sup>3</sup>/h, m<sup>3</sup>/s and cfm

Pe= Static pressure in mm H<sub>2</sub>O, Pa and inwg

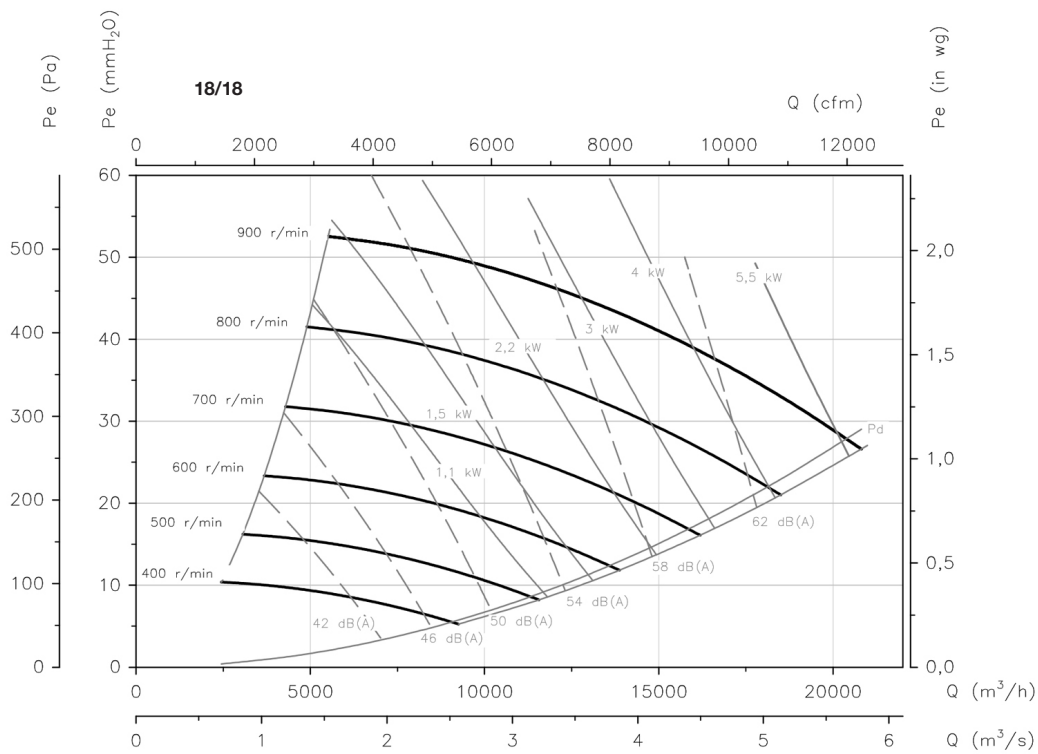
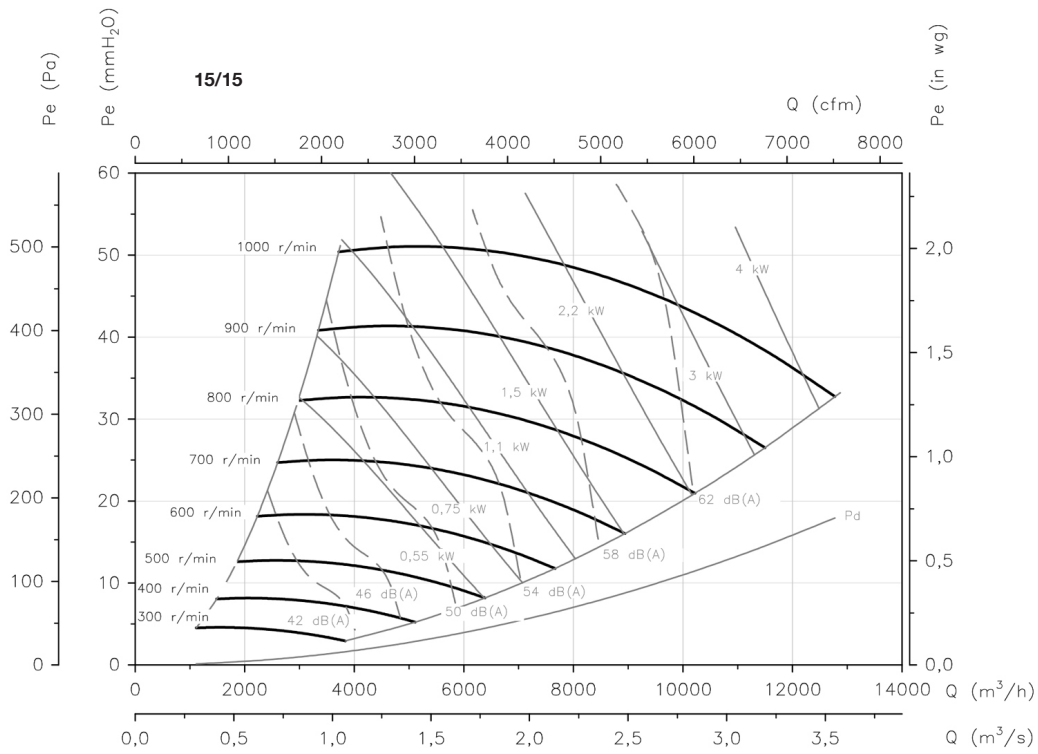



# CENTRIFUGAL FANS AND IN-LINE DUCT EXTRACTOR FANS

## Characteristic curves

Q= Flow rate in m<sup>3</sup>/h, m<sup>3</sup>/s and cfm

Pe= Static pressure in mm H<sub>2</sub>O, Pa and inwg

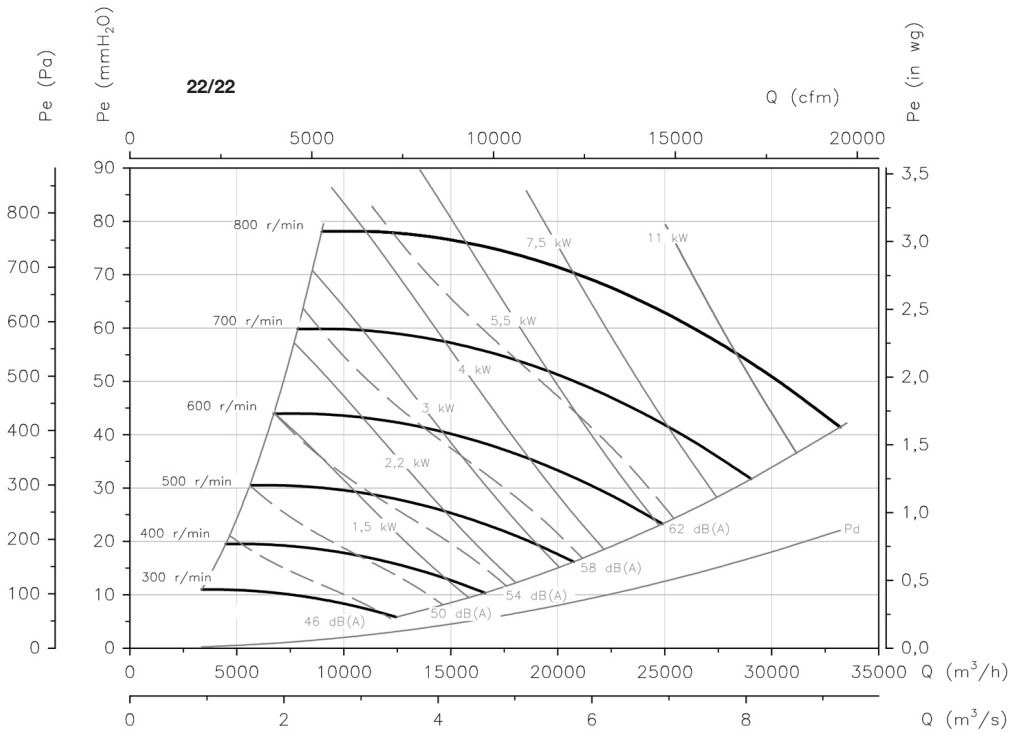
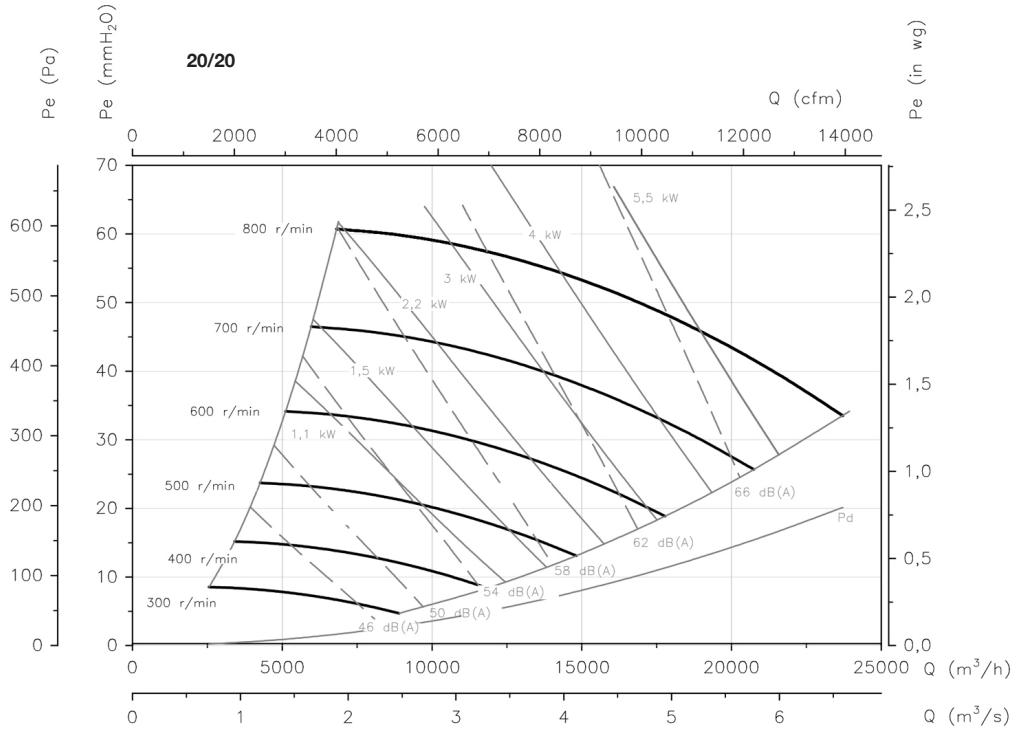



### Characteristic curves

Q= Flow rate in m<sup>3</sup>/h, m<sup>3</sup>/s and cfm

Pe= Static pressure in mm H<sub>2</sub>O, Pa and inwg

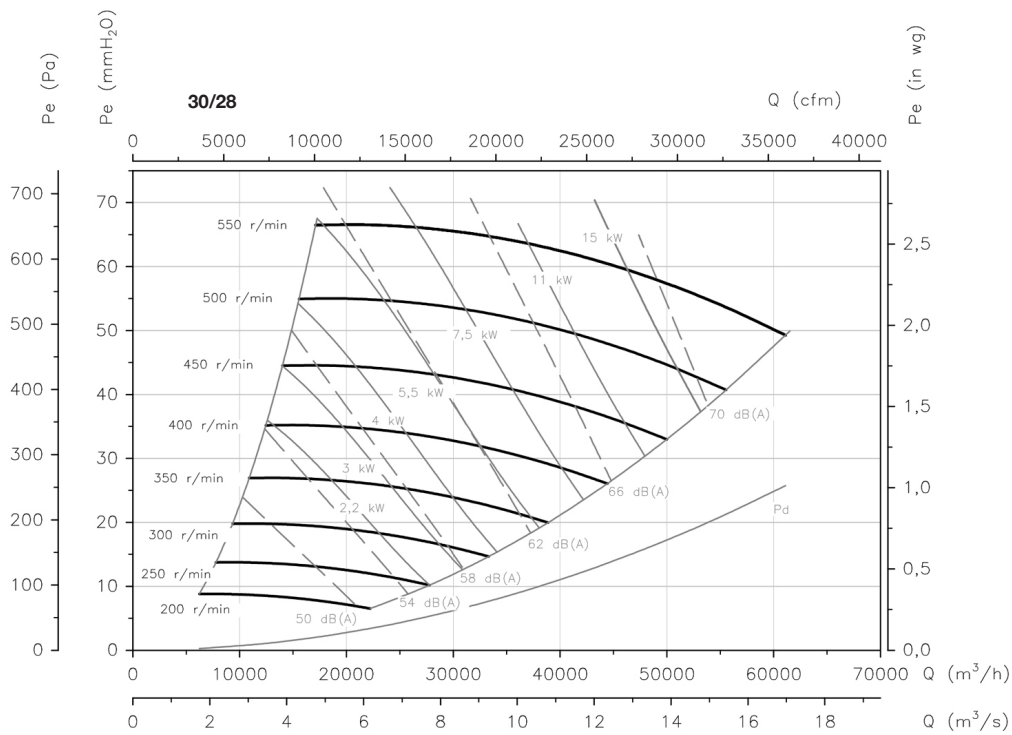
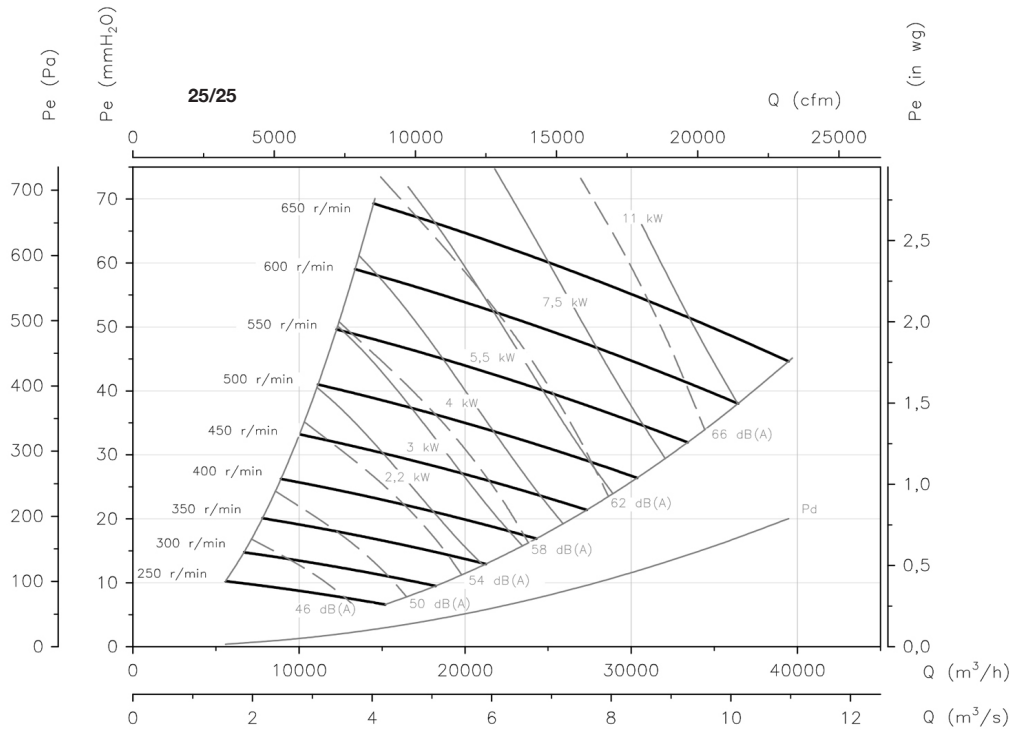

**Characteristic curves**

Q= Flow rate in m<sup>3</sup>/h, m<sup>3</sup>/s and cfm

Pe= Static pressure in mm H<sub>2</sub>O, Pa and inwg



**Load loss curves of units with filters**

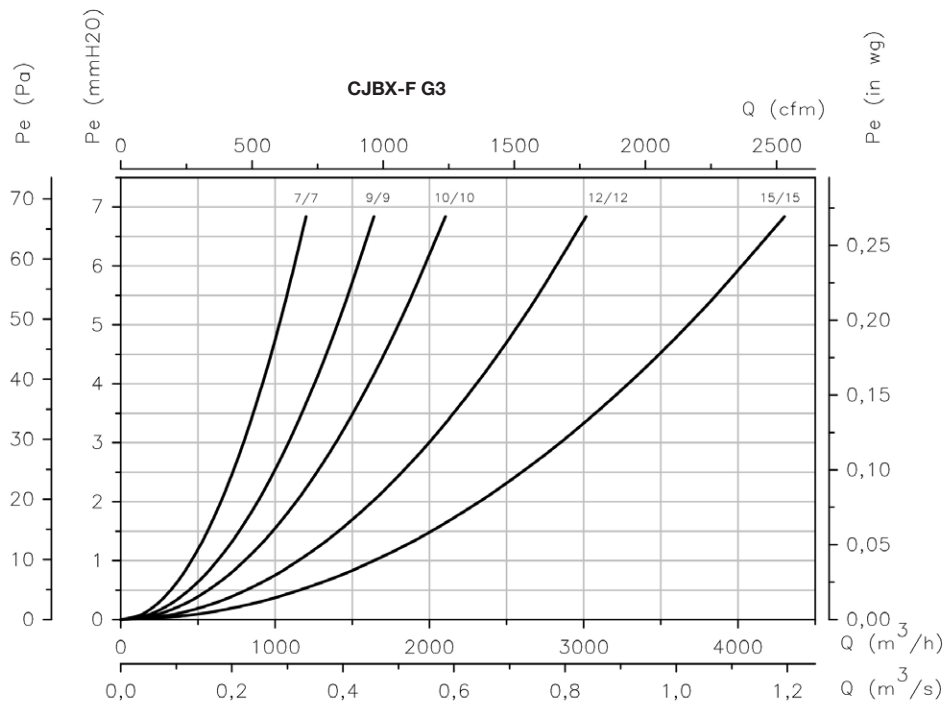
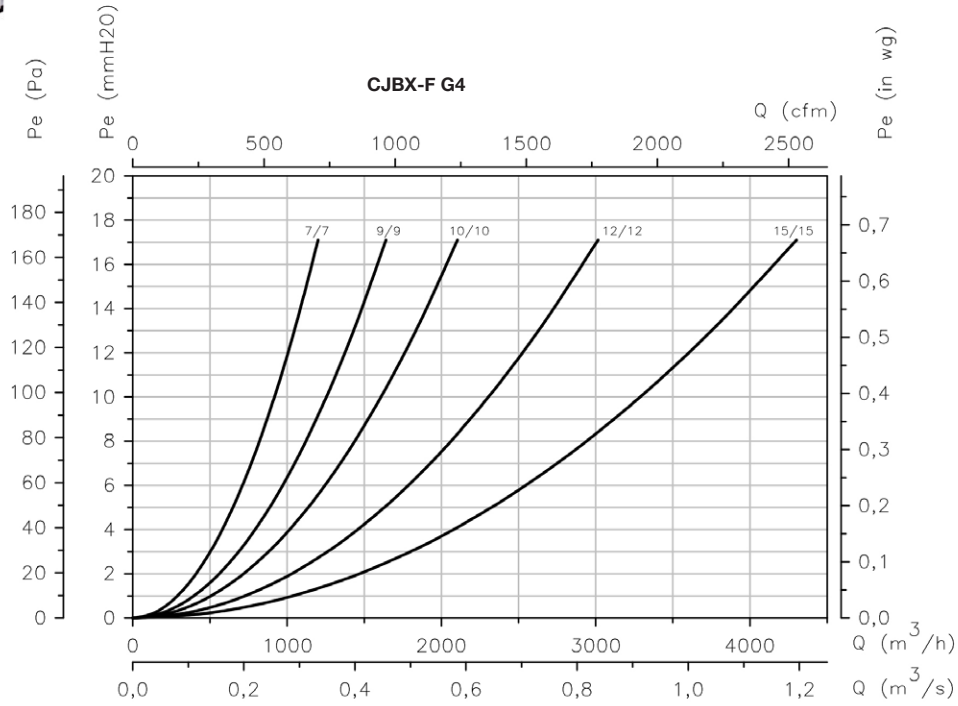

## Characteristic curves

Q= Flow rate in m<sup>3</sup>/h, m<sup>3</sup>/s and cfm

Pe= Static pressure in mm H<sub>2</sub>O, Pa and inwg



### Load loss curves of units with filters

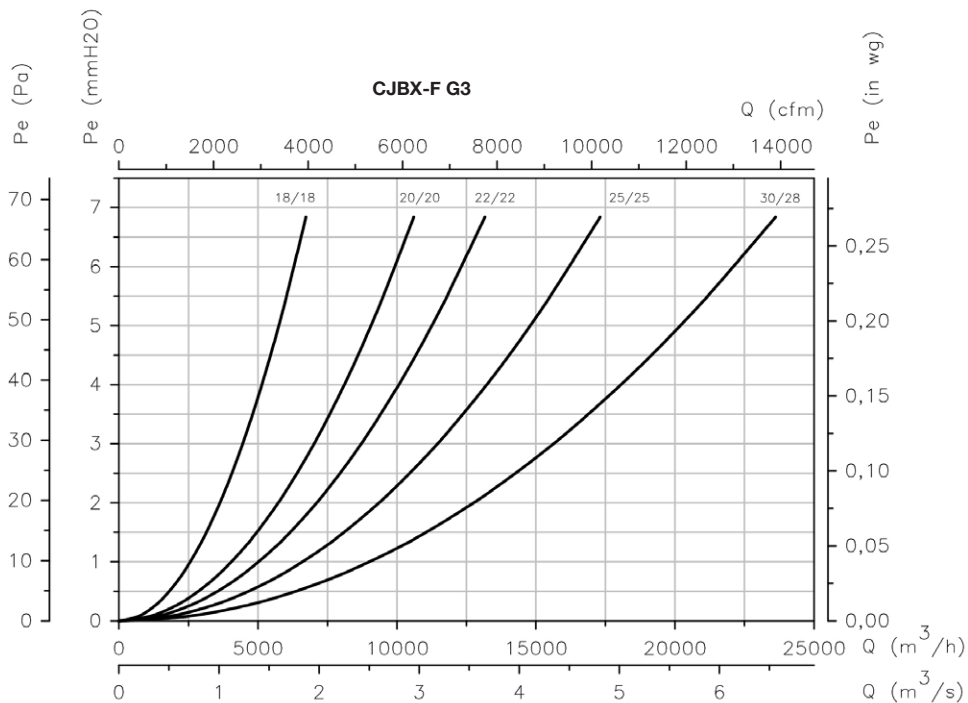
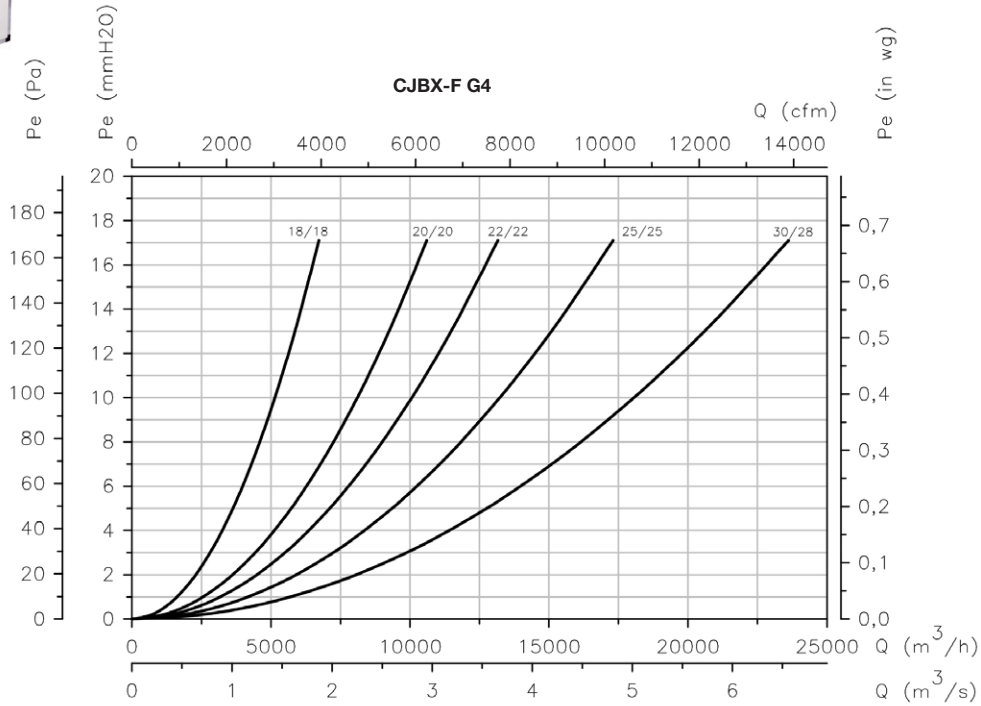

## Accessories

See accessories section.



INT

C2V

RM

VSD3/A-RFT

AET

VIS

TEJ