

# TCR

400 °C/2h and 300 °C/2h centrifugal extractor fans with backward curved impeller

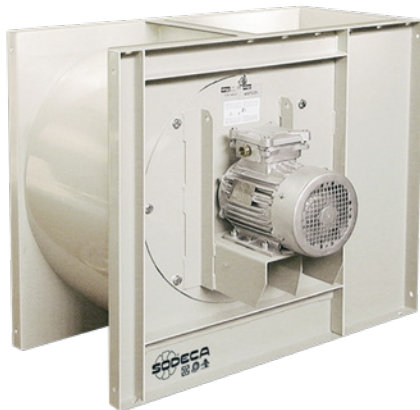

Extremely robust 400 °C/2h medium pressure single inlet centrifugal extractor fans with backward curved impeller for immersed operation in fire risk zones.

**Fan:**

- Sheet steel casing.
- Backward curved impeller in very robust sheet steel, with anti-heat paint.
- Approved in accordance with standard EN 12101-3, with certificate no.: 0370-CPR- 0384.

**Motor:**

- Motors with IE3 efficiency for powers equal to or greater than 0.75 kW, except single-phase, 2-speed and 8-pole.

- Class H motors for S1 continuous operation and S2 emergency use. With ball bearings and IP55 protection.
- Three-phase 230/400 V 50 Hz (up to 3 kW) and 400/690 V 50 Hz (powers greater than 3 kW).
- Maximum temperature of air to be carried: S1 continuous operation -25 °C +120 °C. S2 operation, 300 °C/2h and 400 °C/2h.

**Finish:**

- Anti-corrosive finish in polyester resin, polymerised at 190 °C, after degreasing with phosphate-free nanotechnology treatment.

## Order code

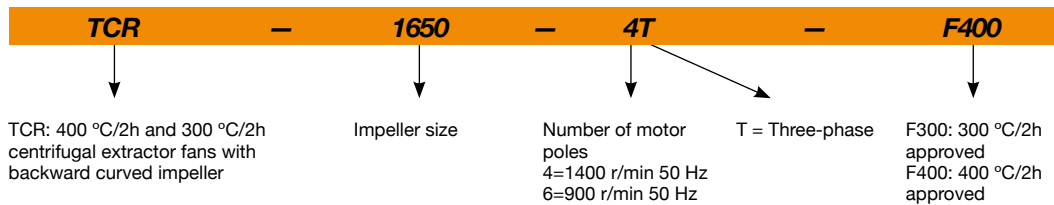

## Orientations

Standard supply LG 270

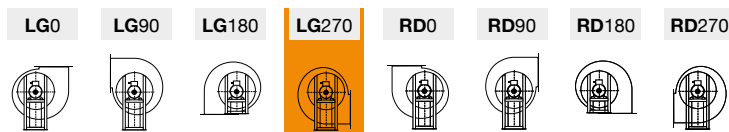

## Technical characteristics

Model	Speed (r/min)	Maximum admissible current (A)			Installed power (kW)	Maximum flow rate (m <sup>3</sup> /h)	Sound pressure level <sup>1</sup> dB (A)	Approx. weight (Kg)
		230V	400V	690V				
TCR-1240-4T IE3	1425	3.08	1.79		0.75	5830	65	76
TCR-1445-4T IE3	1435	4.10	2.37		1.10	8100	68	98
TCR-1650-4T IE3	1140	5.89	3.38		1.50	10600	70	118
TCR-1650-6T IE3	950	3.36	1.93		0.75	7410	60	118
TCR-1856-4T IE3	1455	11.01	6.33		3.00	15240	76	158
TCR-1856-6T IE3	950	4.73	2.72		1.10	10050	68	150
TCR-2063-4T IE3	1465		10.40	6.04	5.50	24490	78	257
TCR-2063-6T IE3	955	6.25	3.62		1.50	16100	68	212
TCR-2271-4T IE3	1480		20.70	11.99	11.00	34760	84	380
TCR-2271-6T IE3	970	12.80	6.36		3.00	23010	75	313

<sup>1</sup> Irradiated sound pressure level in dB(A) at a distance of 3 m.



## Erp. (Energy Related Products)

Information on Directive 2009/125/EC can be downloaded from the SODECA website or the QuickFan selector programme.

### Acoustic characteristics

Irradiated sound power spectrum Lw(A) in dB(A) per Hz frequency band

	63	125	250	500	1000	2000	4000	8000		63	125	250	500	1000	2000	4000	8000
TCR-1240-4T	53	67	73	76	76	77	67	56	TCR-1856-6T	58	66	78	80	77	78	68	57
TCR-1445-4T	56	69	75	80	77	80	75	61	TCR-2063-4T	77	82	88	90	88	85	78	70
TCR-1650-4T	61	71	79	81	80	82	73	63	TCR-2063-6T	66	67	79	79	78	80	70	60
TCR-1650-6T	50	62	69	74	70	66	59	51	TCR-2271-4T	80	81	90	93	95	96	92	79
TCR-1856-4T	66	75	88	84	87	88	82	68	TCR-2271-6T	70	70	84	83	87	87	76	65

### Dimensions mm

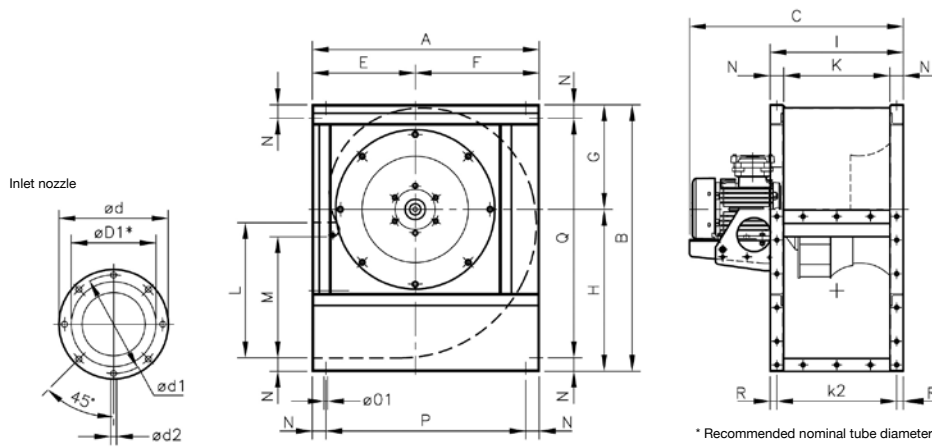

\* Recommended nominal tube diameter

	A	B	C	$\varnothing d$	$\varnothing d1$	$\varnothing D1^*$	$\varnothing d2$	E	F	G	H	M	N	$\varnothing O1$	P	Q	R
TCR-1240-4T	673	790	634	472	444	400	M8	305	368	310	480	358.5	40	11	593	710	20
TCR-1445-4T	765	880	727	522	494	450	M8	350	415	339	541	407	45	11	675	790	20
TCR-1650-4T	832	970	770.5	582	555	500	M10	375	457	378	592	445	45	13	742	880	20
TCR-1650-6T	832	970	770.5	582	555	500	M10	375	457	378	592	445	45	13	742	880	20
TCR-1856-4T	925	1084	857.5	645	615	560	M10	415	510	424	660	493	50	13	825	984	25
TCR-1856-6T	925	1084	828	645	615	560	M10	415	510	424	660	493	50	13	825	984	25
TCR-2063-4T	1037	1218	955	720	688	630	M10	465	572	477	741	530	60	13	917	1098	30
TCR-2063-6T	1037	1218	932	720	688	630	M10	465	572	477	741	530	60	13	917	1098	30
TCR-2271-4T	1173	1375	1149	800	768	710	M12	525	648	538	837	603.5	65	13	1043	1245	32.5
TCR-2271-6T	1173	1375	1112	800	768	710	M12	525	648	538	837	603.5	65	13	1043	1245	32.5

Outlet nozzle

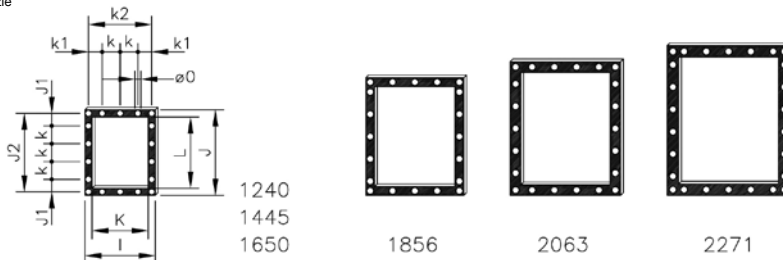

	I	J	J1	J2	K	k	k1	k2	L	$\varnothing O$
TCR-1240	395	480	70	440	315	100	77.5	355	400	11
TCR-1445	445	540	99	498	355	100	102.5	405	450	11
TCR-1650	490	590	87.5	550	400	125	100	450	500	13
TCR-1856	550	660	55	610	450	125	125	500	560	13
TCR-2063	620	750	95	690	500	125	92.5	560	630	13
TCR-2271	690	840	75	775	560	125	62.5	625	710	13

### Characteristic curves

Q= Flow rate in m<sup>3</sup>/h, m<sup>3</sup>/s and cfm

Pe= Static pressure in mm H<sub>2</sub>O, Pa and inwg

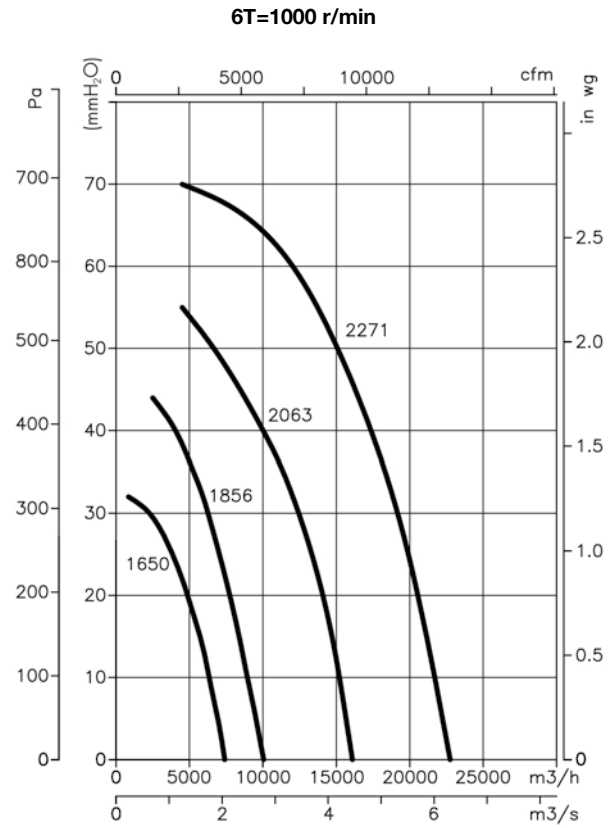
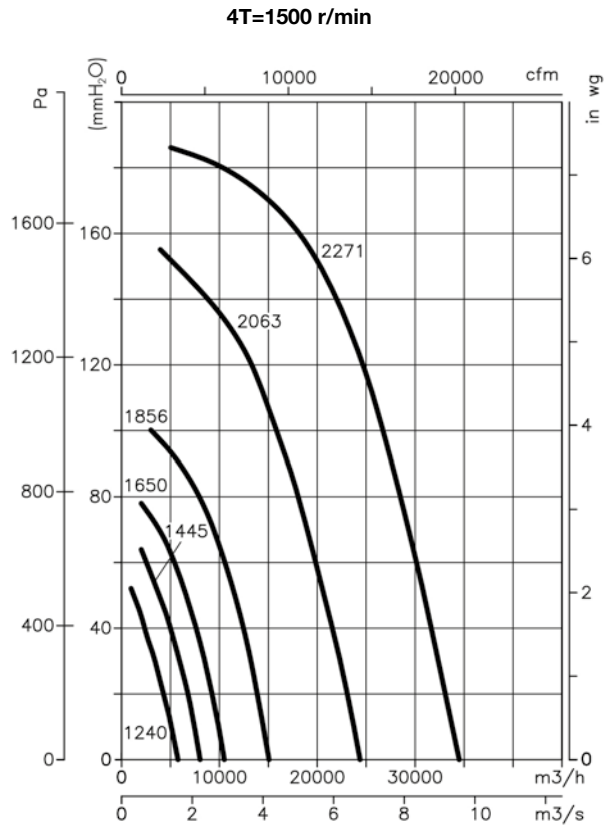

### Accessories



INT



IAT



C2V



RPA



B



BD



BIC



ACE ACE/400



CABLE BOX



AET



CENTRAL CO



VSD3/A-RFT  
- VSD1/A-RFM