

TUNEL JET FAN



Jet fans specially designed for tunnel ventilation. 400 °C/2h and 300 °C/2h certificates, depending on model



Unidirectional jet fan, very robust with cast aluminum impeller for medium thrust. Specially designed for tunnel ventilation and smoke evacuation in case of fire, certified 400 °C/2h and 300 °C/2h according to model.

Fan:

- Large thickness tubular sheet steel casing.
- Motor support welded to the casing.
- Aerodynamic inlet and discharge cone.
- Optimal surface protection by high quality steel.
- One way rotor made of cast aluminium.
- Tubular silencer coupled to both ends that provides high thermal and acoustic insulation.
- Support base specially designed to support the entire set. From the 560 mm diameter it incorporates anti-vibration springs.
- Electrical connection in external terminal box.
- E90 cable with metal protection.
- Support feet or support bench depending on the model included in the set.
- Vibration isolators.
- Security anchor included.
- Approved in accordance with standard EN 12101-3.

Motor:

- Class H motors for S1 continuous operation and S2 emergency use. With ball bearings and IP55 protection.
- Motors with IE3 efficiency for powers equal to or greater than 0.75 kW, except single-phase, 2-speed and 8-pole.
- Three-phase 400/690 V 50 Hz.
- Maximum temperature of air to be carried: S1 -25 °C +40 °C continuous service, also suitable for warm climates with temperatures up to 50 °C. S2 operation, 300 °C/2h, 400 °C/2h.

Finish:

- High protection anti-corrosive steel, special primer and high quality paint for corrosive atmospheres.

On request:

- IP55 standard motors, ATEX and 2 speed motors.
- Total stainless steel construction.
- Hot dip galvanized steel construction.

Order code

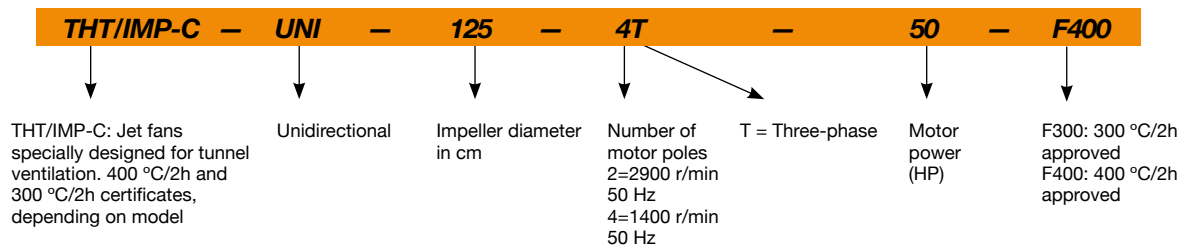

Technical characteristics

Model	Speed (r/min)	Maximum admissible current (A)			Maximum flow rate (m ³ /h)	Thrust (N)	Impulsion speed (m/s)	Installed power (kW)	Sound pressure level ¹ dB (A)	Approx. weight (Kg)
		230V	400V	690V						
THT/IMP-C-UNI-56-2T-12 IE3	2975		18.07	10.44	29500	312	37.6	9.2	64	273
THT/IMP-C-UNI-56-4T-2 IE3	1435	5.89	3.38		14550	76	16.4	1.5	50	197
THT/IMP-C-UNI-63-2T-20 IE3	2935		26.50	15.35	40050	455	37.1	15.0	68	323
THT/IMP-C-UNI-63-4T-3 IE3	1450	7.86	4.52		21550	132	19.2	2.2	53	241
THT/IMP-C-UNI-71-4T-4 IE3	1455	11.01	6.33		28550	182	20.0	3.0	65	279
THT/IMP-C-UNI-80-4T-5.5 IE3	1445		7.95	4.61	36900	239	20.4	4.0	63	414
THT/IMP-C-UNI-90-4T-10 IE3	1460		14.20	8.17	52000	375	22.7	7.5	65	495
THT/IMP-C-UNI-100-4T-15 IE3	1460		20.70	11.99	66500	497	23.5	11.0	63	667
THT/IMP-C-UNI-125-4T-30 IE3	1475		42.20	24.44	98100	692	22.2	22.0	59	980
THT/IMP-C-UNI-125-4T-50 IE3	1480		66.80	38.70	123700	1101	28.0	37.0	62	1110

¹ Sound pressure level in dB(A) at a distance of 10 m and at maximum flow rate.

Acoustic characteristics

Sound power spectrum Lw(A) in dB(A) per Hz frequency band

	63	125	250	500	1000	2000	4000	8000		63	125	250	500	1000	2000	4000	8000
56-2T-12	66	72	90	79	82	81	79	70	80-4T-5.5	65	71	89	78	81	80	78	69
56-4T-2	52	58	76	65	68	67	65	56	90-4T-10	67	73	91	80	83	82	80	71
63-2T-20	70	76	94	83	86	85	83	74	100-4T-15	65	71	89	78	81	80	78	69
63-4T-3	55	61	79	68	71	70	68	59	125-4T-30	61	67	85	74	77	76	74	65
71-4T-4	67	73	91	80	83	82	80	71	125-4T-50	64	70	88	77	80	79	77	68

Dimensions mm

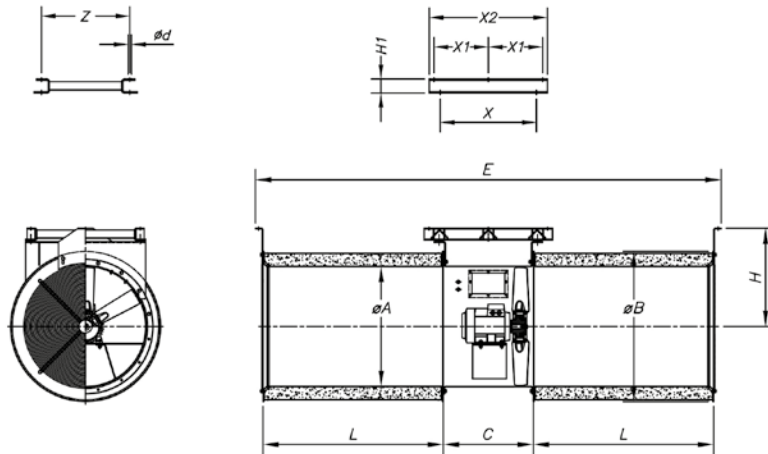

	ØA	ØB	C	L	Ød	E	H	H1	X	X1	X2	Z
THT/IMP-C-UNI-56	560	750	500	1200	12	3093	503	80	558	345	750	465
THT/IMP-C-UNI-63	640	800	650	1200	14	3242	525	80	706	418	900	545
THT/IMP-C-UNI-71	710	900	500	1200	14	3092	600	80	558	345	750	465
THT/IMP-C-UNI-80	800	1000	600	1200	14	3104	655	80	656	395	855	730
THT/IMP-C-UNI-90	900	1100	600	1200	14	3105	675	80	677	405.5	876	825
THT/IMP-C-UNI-100	1000	1200	700	1200	14	3205	730	80	767	450	965	884
THT/IMP-C-UNI-125	1250	1503	650	1350	17	3455	953	100	717	575	1250	1150

Characteristic curves

Q= Flow rate in m³/h, m³/s and cfm Pe= Static pressure in mm H₂O, Pa and inwg

■ Pressure - - - Thrust (N)

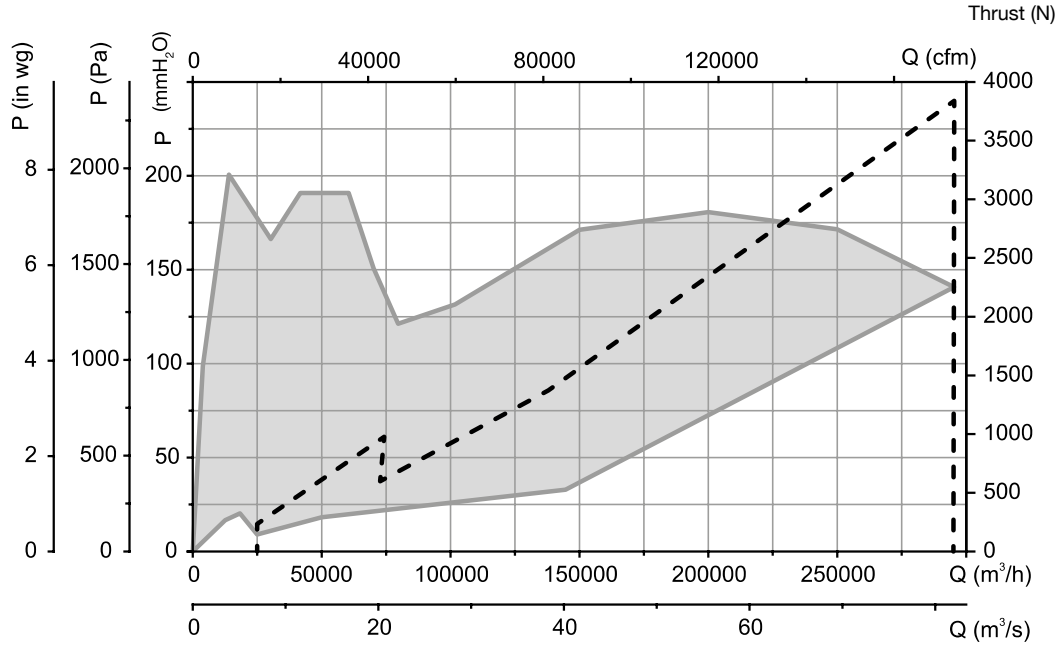

Application example



LONGITUDINAL VENTILATION

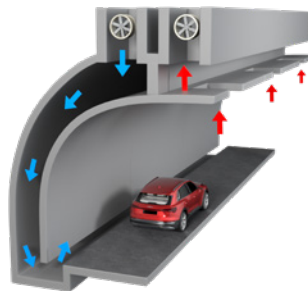

TRANSVERSE VENTILATION



SEMI-TRANSVERSE VENTILATION

Accessories



INT



IAT



CABLE BOX



C2V



AET



CENTRAL CO



VSD3/A-RFT
- VSD1/A-RFM



P-400



R/THT

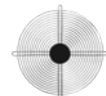

RT